

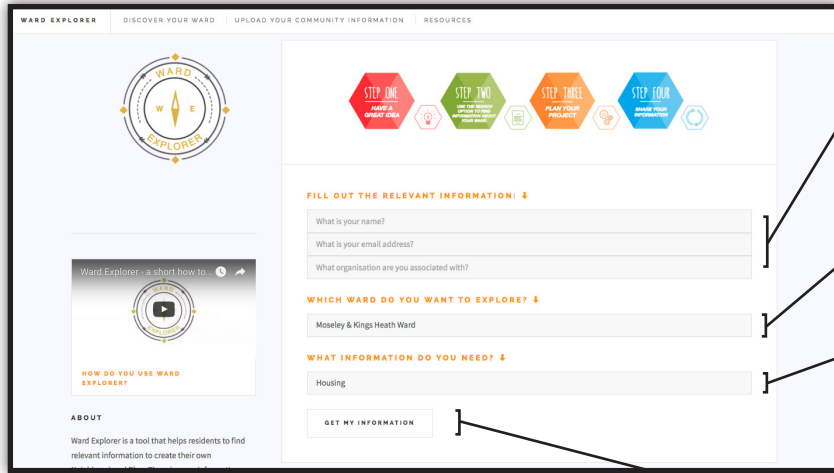

# A BITESIZE GUIDE TO FINDING DATA ON WARD EXPLORER



## STEP ONE:

### FILL OUT THE RELEVANT INFORMATION: ↓

What is your name?  
What is your email address?  
What organisation are you associated with?

Fill out your personal information, this is optional in the beta version of Ward Explorer.

## STEP TWO:

### WHICH WARD DO YOU WANT TO EXPLORE? ↓

✓ Moseley & Kings Heath Ward  
Balsall Heath

Chooses your area.

## STEP THREE:

### WHAT INFORMATION DO YOU NEED? ↓

✓ Choose one  
Local economy  
Transport  
Leisure  
Housing  
Community  
Planning  
Sustainability

Choose what kind of information you are looking for.

## STEP FOUR:

GET MY INFORMATION

Click the "Get my information" button, you will be taken to a page like the example below.

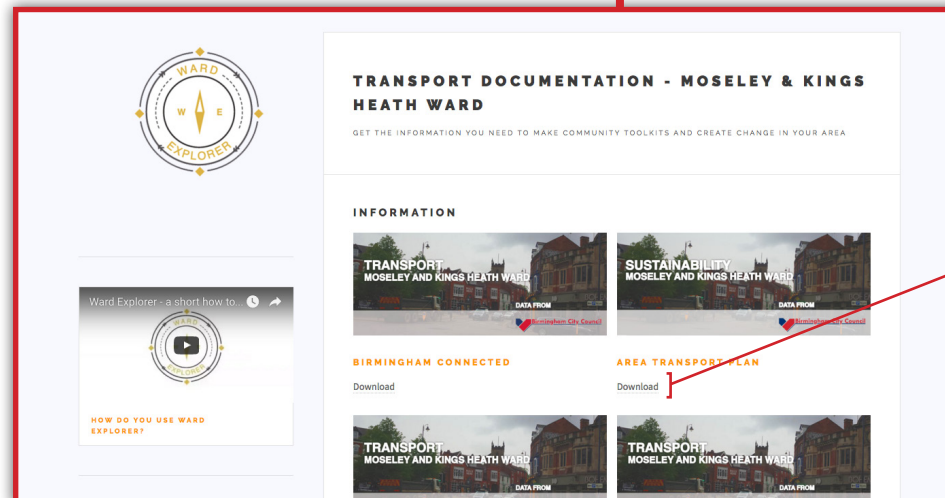

Click "Download" on the information you need and it will automatically download to your computer.

For a more indepth demonstration on how to use Ward Explorer there is a video at [www.wardexplorer.com](http://www.wardexplorer.com)